

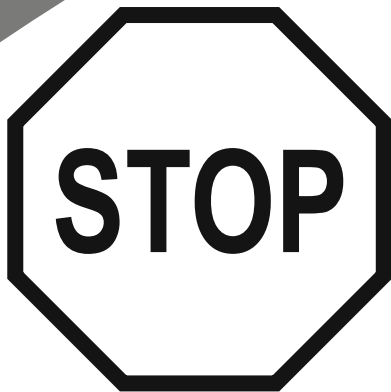

#90423E / #90425E / #90426E / #90389E

**Power Steel™ Pools
OWNER'S MANUAL**

Para la instrucción en español,
visite bestwaycorp.com/support



**DO NOT RETURN THIS ITEM TO THE STORE OR
WEBSITE WHERE IT WAS PURCHASED. PLEASE
VISIT BESTWAYCORP.COM/SUPPORT
FOR QUESTIONS, OR FOR DEFECTIVE OR
WARRANTY CLAIMS.**

Website: bestwaycorp.com/support

THIS PRODUCT IS COMPLIANT TO ANSI/ APSP 4 AMERICAN NATIONAL STANDARD FOR
ABOVEGROUND POOLS / ONGROUND RESIDENTIAL SWIMMING POOLS & INTERNATIONAL SWIMMING
POOL & SPA CODE (ISPSC)



WARNING

smooth out the bottom

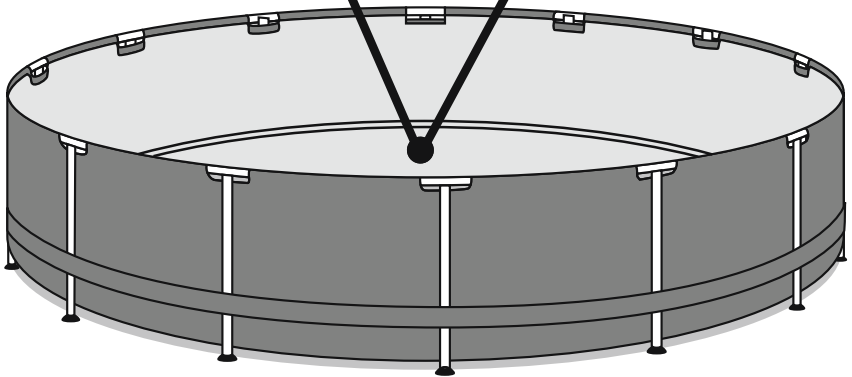
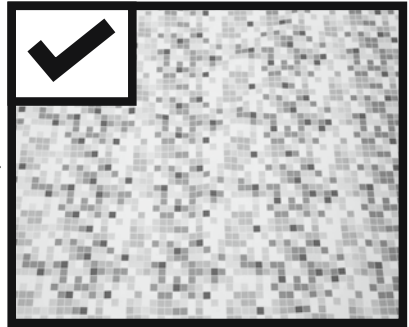
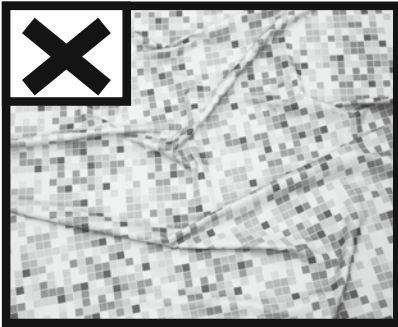

Put 1 to 2 in. of water in the pool to cover the floor. Once pool floor is slightly covered, gently smooth out all wrinkles. Start in the center of the pool and work your way clockwise to the outside.



No sitting or standing on the top rails.

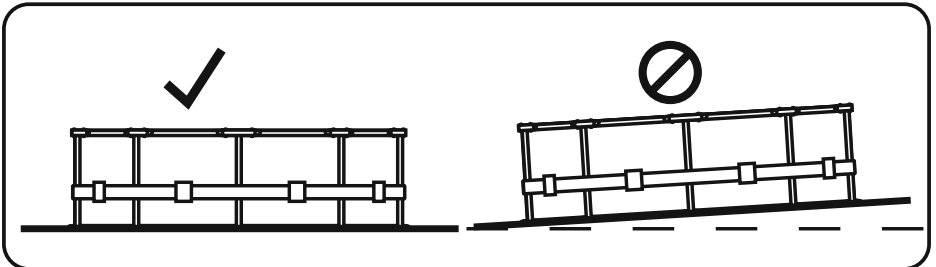

The pool must be set up on a completely flat and level surface. Please do not install the pool if the surface is inclined or sloped. Failure to do so may result in the product collapsing which may cause serious injury.

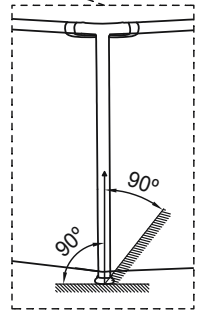
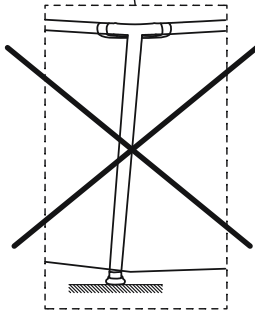
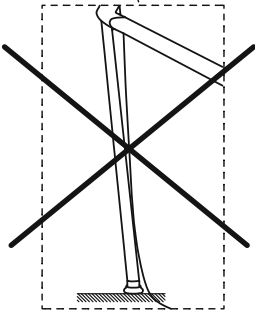
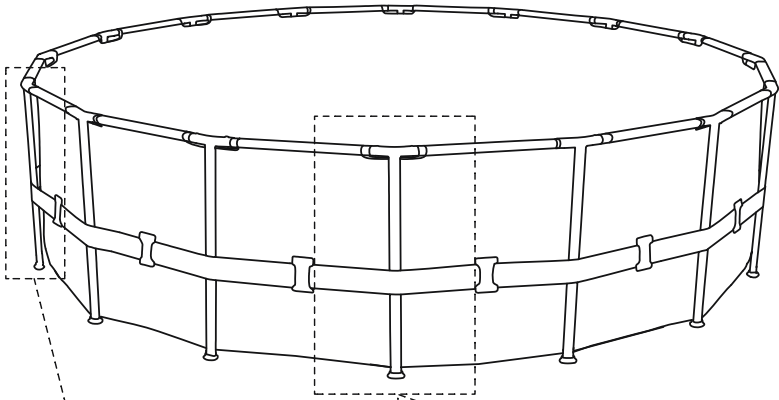

After the installation of the pool's steel frame is completed, ensure that the verticals are perpendicular to the ground. If they aren't, the verticals could be bent or deformed.

WARNING

 WARNING	
NO DIVING! Shallow water.  You can be permanently injured.	PREVENT DROWNING  Watch children at all times.

Only for outdoor use.

Teach your children to swim.

Never dive, jump, or slide into the pool.

Adult supervision is always required.

Parents should learn CPR.

Never swim alone.

Keep all electrical radios, speakers and other appliances away from the swimming pool.

When you touch the filter, pump, or electrical parts, be sure the ground under your feet is "Bone Dry."

All electrical outlets should have a GFCI and connections should be a minimum of 5 feet (1.52 m) from the outside perimeter of the wall of the pool. From 5–10 feet (1.52–3.05 m), there should be either a fixed connection (outlet box) or twist lock connection with a GFCI.

Connect power cords to a 3-wire grounding-type outlet only.

Keep all breakable objects out of the pool area.

Alcohol consumption and pool activities do not mix. Never allow anyone to swim, dive or slide under the influence of alcohol or drugs.

Severe electrical shock could result if you install your pump or filter on a deck. The pump or filter could fall into the water, causing severe shock or electrocution. Do not install on a deck or other surface at, above, or slightly below the top rail of the pool.

Do not use the pool during severe weather conditions, i.e. electrical storms, tornadoes, etc.

Be aware of overhead power lines when vacuuming your pool or using a telescoping pole.

Do not allow diving, climbing, sitting, or standing on the top rails of the pools.

Do not allow roughhousing and horseplay.

Do not engage in extended breath holding activities underwater; you may black out and drown.

Install a pool ladder(s) or staircase for entry and exit from the pool.

Keep deck clean and clear of objects that may create a tripping hazard.

Check regularly for signs of wear or loose bolts that could make the deck unsafe.

Instruct pool users about the proper use of all pool ladder(s) and staircases.

Face ladder going up or down.

Allow only one person at a time on the ladder.

Check all nuts and bolts regularly to ensure that the ladder stays sturdy.

Remove or secure the ladder to prevent entry to pool when not in use.

Please contact pool site dealer or manufacturer for additional safety signs if deemed necessary.

For pool service, select a certified pool professional.

Any equipment connected to the circulation systems shall be positioned so as to prevent their being used as a means of access to the pool by young children.

The installation must comply with the codes of the authority having jurisdiction and may require permits for building, plumbing electrical, zoning, etc.

The pool shall be located a minimum distance of 6 ft. (1.83 m) from any electrical receptacle.

All 125 volt, 15 and 20 ampere receptacles located within 20 ft. (6.0 m) of the pool shall be protected by a ground fault circuit interrupter (GFCI). The 20 ft. (6 m) distance is measured via the shortest straight line distance the supply cord would follow without piercing a floor, wall, ceiling, doorway, window, or other permanent barrier.

Prior to use of the pool, the installer shall affix all no diving signs and safety signs in accordance with installation instructions so they can be easily visible.

A barrier is necessary to provide protection against potential drowning and near drowning. Barriers are not a substitute for the constant supervision of children.

A list of emergency telephone numbers shall be posted, such as the nearest available police, fire, ambulance, and/or rescue unit. These numbers are to be kept near the telephone that is closest to the pool.

Toys, chairs, tables, or similar objects that a young child could climb shall be at least 4 feet (1219 mm) from the pool.

If deck is used by the installer, it will need to comply with APSP-8.

Basic lifesaving equipment, including one of the following, shall be on hand at all times: a. A light, strong, rigid pole (shepherd's crook) not less than 12 ft. (3.66 m) long. b. A minimum 1/4 in. (6 mm) diameter rope as long as 1 1/2 times the maximum width of the pool or 50 feet (15.24 m), whichever is less, which has been firmly attached to a Coast Guard-approved ring buoy, or similarly approved flotation devices.

The swimming pool cover is not designated as a safety barrier. Please use artificial lighting during nighttime pool use, to illuminate all safety signs, ladders, steps, deck surfaces and walks.

The pool is subject to wear and deterioration. If not maintained properly, certain types of excessive or accelerated deterioration can lead to failure of the pool structure that might release large quantities of water that could cause bodily harm and property damage.

The bottom of the pool shall be visible at all times from the outside perimeter of the pool.

The installer of the vinyl liner shall affix on the original or replacement liner, or on the pool structure, all safety signs in accordance with the manufacturer's instructions.

If you have a filter pump, refer to the pump's manual for instructions.

The ladder shall be located on a solid base and the ladder shall be installed per the ladder's instructions.

Publications are available that describe the risk of drowning, entrapment, and diving accidents. Available publications related to pool safety include the Association of Pool and Spa Professionals' (APSP) booklets entitled: The Sensible Way to Enjoy Your Aboveground/Onground Swimming Pool, Children Aren't Waterproof, Pool and Spa Emergency Procedures for Infants and Children, Layers of Protection, and the latest published edition of ANSI/APSP-8 Model Barrier Code for Residential Swimming Pools, Spas, and Hot Tubs.

For additional safety information, see www.APSP.org. THIS PRODUCT IS COMPLIANT TO ANSI/APSP 4 AMERICAN NATIONAL STANDARD FOR ABOVEGROUND POOLS / ONGROUND RESIDENTIAL SWIMMING POOLS & INTERNATIONAL SWIMMING POOL & SPA CODE (ISPCS) (Only for USA & only for pools with a water depth of more than 36in. (914mm))

Please read carefully and keep for future reference.

Assembly usually takes approximately 20-30 minutes with 2-3 people.

Part descriptions

NOTE: Some parts already have been installed on the pool.

POWER STEEL™

A



Top Rail

SIZE	ITEM#	PART CODE	QTY
18 ft. x 48 in. (5.49 m x 1.22 m)	#256002001043	P61775ASS18	18
22 ft. x 52 in. (6.71 m x 1.32 m)	#256002001044	P04044	22
22 ft. x 52 in. (6.71 m x 1.32 m)	#B90389	P05224	22
26 ft. x 52 in. (7.92 m x 1.32 m)	#256002001010	P05224	26

B



Vertical Pool Leg

SIZE	ITEM#	PART CODE	QTY
18 ft. x 48 in. (5.49 m x 1.22 m)	#256002001043	P61776ASS18	18
22 ft. x 52 in. (6.71 m x 1.32 m)	#256002001044	P04045	22
22 ft. x 52 in. (6.71 m x 1.32 m)	#B90389	P61352ASS16	22
26 ft. x 52 in. (7.92 m x 1.32 m)	#256002001010	P61352ASS16	26

C



T-connector

SIZE	ITEM#	PART CODE	QTY
18 ft. x 48 in. (5.49 m x 1.22 m)	#256002001043	P61777ASS18	18
22 ft. x 52 in. (6.71 m x 1.32 m)	#256002001044	P04046	22
22 ft. x 52 in. (6.71 m x 1.32 m)	#B90389	P61763ASS18	22
26 ft. x 52 in. (7.92 m x 1.32 m)	#256002001010	P61764ASS18	26

D



Pin

SIZE	ITEM#	PART CODE	QTY
18 ft. x 48 in. (5.49 m x 1.22 m)	#256002001043	P61778ASS18	38
22 ft. x 52 in. (6.71 m x 1.32 m)	#256002001044	P61778ASS18	46
22 ft. x 52 in. (6.71 m x 1.32 m)	#B90389	P61759ASS18	46
26 ft. x 52 in. (7.92 m x 1.32 m)	#256002001010	P61759ASS18	54

E



Footing

SIZE	ITEM#	PART CODE	QTY
18 ft. x 48 in. (5.49 m x 1.22 m)	#256002001043	P61779ASS18	18
22 ft. x 52 in. (6.71 m x 1.32 m)	#256002001044	P61779ASS18	22
22 ft. x 52 in. (6.71 m x 1.32 m)	#B90389	P61760ASS18	22
26 ft. x 52 in. (7.92 m x 1.32 m)	#256002001010	P61760ASS18	26

F



Pin Gasket

SIZE	ITEM#	PART CODE	QTY
18 ft. x 48 in. (5.49 m x 1.22 m)	#256002001043	P61774ASS18	38
22 ft. x 52 in. (6.71 m x 1.32 m)	#256002001044	P61774ASS18	46
22 ft. x 52 in. (6.71 m x 1.32 m)	#B90389	P61755ASS18	46
26 ft. x 52 in. (7.92 m x 1.32 m)	#256002001010	P61755ASS18	54

G



Liner

SIZE	ITEM#	PART CODE	QTY
18 ft. x 48 in. (5.49 m x 1.22 m)	#256002001043	P04090	1
22 ft. x 52 in. (6.71 m x 1.32 m)	#256002001044	P04091	1
22 ft. x 52 in. (6.71 m x 1.32 m)	#B90389	P00947	1
26 ft. x 52 in. (7.92 m x 1.32 m)	#256002001010	P00827	1

H



Hose Adaptor

SIZE	ITEM#	PART CODE	QTY
18 ft. x 48 in. (5.49 m x 1.22 m)	#256002001043	P6H1420ASS16	1
22 ft. x 52 in. (6.71 m x 1.32 m)	#256002001044	P6H1420ASS16	1
22 ft. x 52 in. (6.71 m x 1.32 m)	#B90389	P6H1420ASS16	1
26 ft. x 52 in. (7.92 m x 1.32 m)	#256002001010	P6H1420ASS16	1

I



Stopper

SIZE	ITEM#	PART CODE	QTY
18 ft. x 48 in. (5.49 m x 1.22 m)	#256002001043	P6C1418ASS19	2
22 ft. x 52 in. (6.71 m x 1.32 m)	#256002001044	P6C1418ASS19	2
22 ft. x 52 in. (6.71 m x 1.32 m)	#B90389	P6C1418ASS19	2
26 ft. x 52 in. (7.92 m x 1.32 m)	#256002001010	P6C1418ASS19	2

J



Drain Valve Cap

SIZE	ITEM#	PART CODE	QTY
18 ft. x 48 in. (5.49 m x 1.22 m)	#256002001043	P6H1158ASS16	1
22 ft. x 52 in. (6.71 m x 1.32 m)	#256002001044	P6H1158ASS16	1
22 ft. x 52 in. (6.71 m x 1.32 m)	#B90389	P6H1158ASS16	1
26 ft. x 52 in. (7.92 m x 1.32 m)	#256002001010	P6H1158ASS16	1

K



Control Valve

SIZE	ITEM#	PART CODE	QTY
18 ft. x 48 in. (5.49 m x 1.22 m)	#256002001043	P6(H)510ASS16	1
22 ft. x 52 in. (6.71 m x 1.32 m)	#256002001044	P6(H)510ASS16	1
22 ft. x 52 in. (6.71 m x 1.32 m)	#B90389	P6(H)510ASS16	1
26 ft. x 52 in. (7.92 m x 1.32 m)	#256002001010	P6(H)510ASS16	1

L



Pool Inlet Strainer

SIZE	ITEM#	PART CODE	QTY
18 ft. x 48 in. (5.49 m x 1.22 m)	#256002001043	P6H1317ASS16	1
22 ft. x 52 in. (6.71 m x 1.32 m)	#256002001044	P6H1317ASS16	1
22 ft. x 52 in. (6.71 m x 1.32 m)	#B90389	P6H1317ASS16	1
26 ft. x 52 in. (7.92 m x 1.32 m)	#256002001010	P6H1317ASS16	1

CHOOSE THE CORRECT LOCATION

NOTE: The pool must be set up on a completely flat and level surface. Please do not install the pool if the surface is inclined or sloped.

Correct conditions to set up the pool:

- The selected location has to be capable of uniformly supporting the weight for the entire time the pool is installed; moreover the location must be flat and must be cleared of all objects and debris including stones and twigs.
- We recommend positioning the pool away from any objects children could use to climb into the pool.

NOTE: Position the pool near an adequate drainage system to deal with overflow or to discharge the pool.

Incorrect conditions to set up the pool:

- On uneven ground the pool may collapse, causing serious personal injury and/or damage to personal property and will void the warranty and prevent any service claims.
- Sand should not be used to create a level base; the ground must be dug out if necessary.
- Directly under overhead power lines or trees. Be sure the location does not contain underground utility pipes, lines or cables of any kind.
- Do not set up the pool on driveways, decks, platforms, gravel or asphalt surfaces. The selected location should be firm enough to withstand the pressure of the water; Mud, sand, soft / loose soil or tar are not suitable.
- Grass or other vegetation under the pool will die and may cause odors and slime to develop, therefore we recommend removing all grass from the selected pool location.
- Avoid areas prone to aggressive plant and weed species that may grow through the ground cloth or liner.

NOTE: Check with your local city council for by-laws

relating to fencing, barriers, lighting and safety requirements and ensure you comply with all laws.

NOTE: If have a filter pump, refer to the pump's manual for instructions.

NOTE: The ladder must match the pool size and should be used only for entering and exiting the pool. It is forbidden to exceed the permitted payload of the ladder. Check regularly if the ladder is properly assembled.

Installation

1. Lay out all parts and check that you have the correct quantities as listed in the components list. If you are missing any part do not assemble the pool. Contact Bestway Customers Service for assistance.
2. Spread out the pool and make sure the pool is right side up. Let it sit exposed to direct sunlight for 1 hour or more so that the pool is more flexible during set up.
3. Place the pool near an adequate drainage system to deal with overflow water and ensure the pool's inlet A and outlet B are correctly positioned to allow your filter pump to connect to a power source.

NOTE: Do not use extension power cords to power your pump.

ATTENTION: Do not drag the pool on the ground, this can damage the pool.

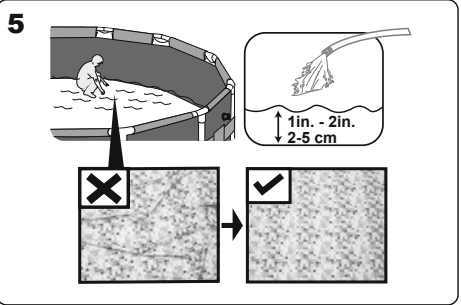
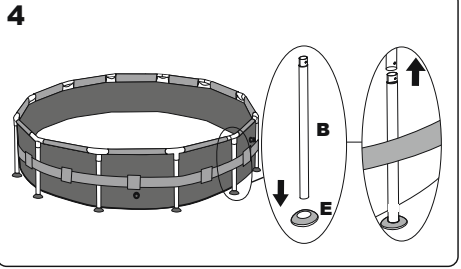
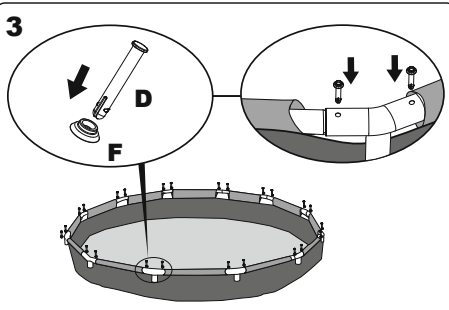
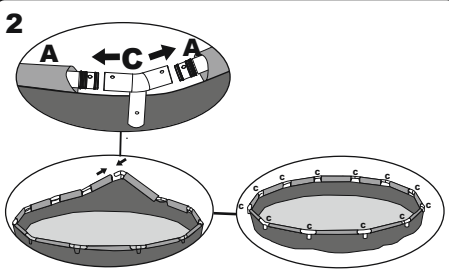
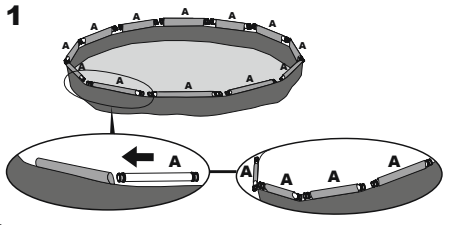

Connection Valve Assembly

For pool with connection valve.

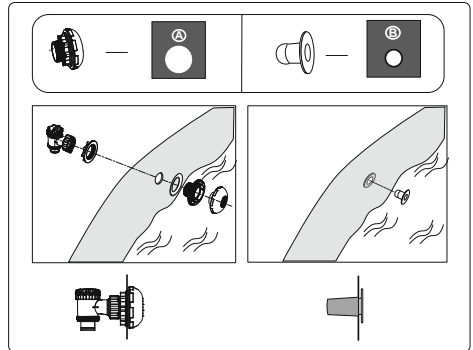

Filling Pool with Water

ATTENTION: Do not leave pool unattended while filling with water.

1. Fill pool until water capacity is 90%. DO NOT OVERFILL as this could cause the pool to collapse. In times of heavy rainfall you may need to empty some of the water to ensure the level is correct.
2. When filling the pool is completed, check that the water is not collecting more on any side to ensure the pool is level.

IMPORTANT: If the pool is not level, drain the water and re-level the ground by digging it out. Never attempt to move the pool with water in it as serious personal injury or damage to the pool may result.

WARNING: Your pool may contain a great deal of pressure. If your pool has a bulge or any uneven sides, then

- the pool is not level. The sides may burst and the water may discharge suddenly causing serious personal injury and/or damage to property.
3. Check the pool for any leaks at the valves or seams. Check the ground cloth for any evident water loss. Do not add chemicals until this has been done.

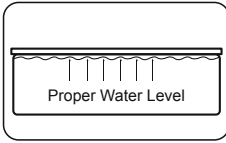
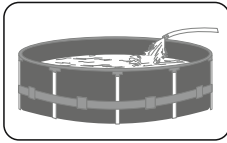

NOTE: Drawings for illustration purpose only. May not reflect actual product. Not to scale.

Pool Maintenance

If you do not adhere to the maintenance guidelines below, you and your children's health could be at risk.

IMPORTANT: If you don't adhere to the ideal values of the water chemicals, the PVC can be damaged and become discolored.

The following table lists the sequence of the tests that should be carried out to obtain the ideal values. Regularly check the pH value and chlorine concentration weekly and adjust as needed to reach the ideal values.

TEST	IDEAL VALUES
pH value	7.4 – 7.6
Cyanuric acid	30 – 50 ppm
Free chlorine	2 – 4 ppm
Chlorine compound	0
Algae	None visible
Calcium hardness	200 – 400 ppm

To keep your pool clean:

1. Contact your local pool supply shop for advice and purchase of chemicals and pH kits. One of the most important factors to increase the life of the liner is to continuously keep the pool water clean and healthy. Please strictly follow the instructions from professional technicians for the water treatment through the use of chemicals.
2. Locate a bucket of water next to pool to clean users' feet before entering the pool.
3. Cover the pool when not in use.
4. Skim pool regularly to avoid settled dirt.
5. Check and wash the filter cartridge regularly.
6. Gently clean any scum from below the top ring with a clean cloth.
7. In case of rain water, check that the water level is not higher than the recommended amount. If so, YOU HAVE TO DISCHARGE THE EXCESS WATER.

Proper maintenance can maximize the life of your pool.

ATTENTION: Do not use the pump when pool is in use.

During swimming pool season, the filtration system must be used every day. Be sure to run it long enough to ensure the pool water is adequately filtrated and circulated until it is clean.

Dismantling

1. Unscrew the drain valve cap on the outside of the pool counter clockwise and remove.
2. Connect the adaptor to the hose and put the other end of the hose in the area where you are going to drain your pool. (Check local regulations for drainage by-laws).
3. Screw control ring of the hose adaptor clockwise onto the drain valve. The drain valve will be open and water will start to drain automatically.

ATTENTION: Water flow can be controlled with the control ring.

4. When draining is finished, unscrew the control ring to close the valve.
5. Disconnect the hose.
6. Screw the cap back onto the drain valve.
7. Air dry pool.

ATTENTION: Do not leave the drained pool outside.

Storage and Winterization

1. Please remove all accessories and spare parts of the pool and be sure they are clean and dry before you store them.
2. Once pool is completely dry, sprinkle with talcum powder to prevent pool from sticking together. Carefully fold pool. If pool is not completely dry, mold may result and damage the pool liner.
3. Store liner and accessories in a dry place with a moderate temperature between 5°C / 41°F and 38°C / 100°F.
4. During the rainy season, pool and accessories should be stored as per above instructions.
5. Improper draining of the pool might cause serious personal injury and/or damage to personal property.
6. We strongly recommend the pool is disassembled and stored in a dry location out of children's reach during the off season (winter months).

Important: When preparing the pool for storage, make sure there is 10 cm (4 in.) between the folding point and the circumference of each window. The windows should not be creased or be folded during storage.

Repair

Check pool for any leaks from valves or seam and check the ground cloth for any evident water loss. Do not add chemicals until this has been done.

NOTE: In the event of a leak, patch your pool using the underwater adhesive repair patch provided.

UnderWater Adhesive Repair Patch (the size of broken $\leq 2.5\text{cm}$)

NOTE: Do not need to drain the pool, repair patch can be used underwater.

1. Find the broken area.

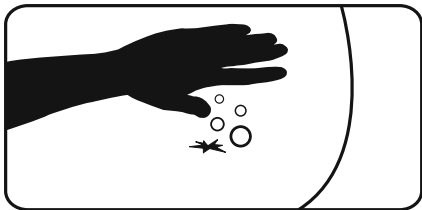

2. Clean the area to be repaired.



3. Carefully peel patch.

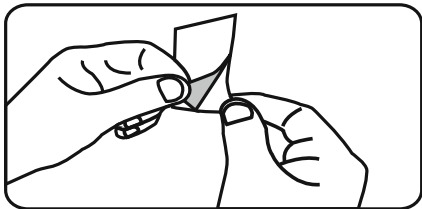

4. Apply the repair patch to repaired site and smooth out any air bubbles. Press for 30 seconds.

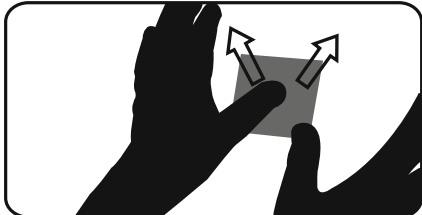

5. Wait 30 minutes before use.



Tritech PVC Material Repair Patch (2.5cm \leq the size of broken $\leq 5\text{ cm}$)

NOTE: Glue is not included due to shipping constraints. You can find PVC or silicone-based glue at most retail outlets. Carefully read the warning labels and closely follow instructions on the back of glue before attempting the following repair steps.

1. Discharge the water, fully clean and dry area to be repaired.



2. Cut the correct size from the Tritech PVC Material Repair Patch.

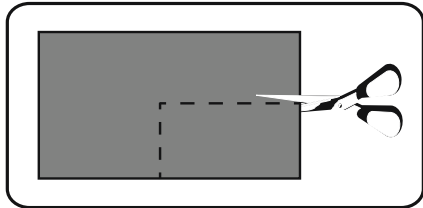

3. Apply only the amount of glue (not included) needed to cover the repair site.

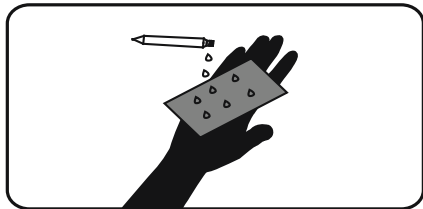

4. Press the repair patch firmly to repair site for 30 seconds.

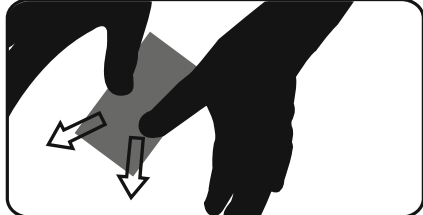

5. Wait 30 minutes before use.





©2020 The Coleman Company, Inc.



is a registered trademark of The Coleman Company, Inc., used under license.

Manufactured by **Bestway**

©2020 Bestway (USA) Inc., 3411 E. Harbour Drive, Phoenix, Arizona 85034, United States of America

®™ Trademarks used in some countries under license to

Bestway Inflatables & Material Corp., No.3065 Cao An Road, Shanghai, 201812, China

Exported by Bestway (Hong Kong) International Ltd./Bestway Enterprise Company Limited

Suite 713, 7/Floor, East Wing, Tsim Sha Tsui Centre, 66 Mody Road, Kowloon, Hong Kong

www.bestwaycorp.com